

- MINIMUM FOUNDATION SPECS AS FOLLOWED:**
 - 16" DIAMETER BY 48" DEEP IN UNDISTURBED SOIL OR INTO BACKFILLED GRANULAR MATERIAL WITH 95% PROCTOR DENSITY COMPACTION.
 - 4000 PSI COMPRESSIVE STRENGTH AT 28 DAYS WITH 5% -8% AIR ENTRAINMENT AND 5"-7" SLUMP.
 - SOIL CONDITIONS ALLOWABLE AVERAGE SOIL STRESS FOR LATERAL DESIGNS, S1= 1000PSI MIN.
 - STANDARD WIND EXPOSURE CATEGORY B= 90MPH
 - GEOTECHNICAL EVALUATION, SOIL BORING AND SITE TESTING MAY BE REQUIRED PER YOUR CITY'S GUIDELINES.
- GOVERNING BUILDING CODES:**
 - MICHIGAN BUILDING CODE BASED ON IBC, LATEST EDITION- OCCUPANCY CATEGORY II
- OTHER APPLICABLE CODES:**
 - ASCE/ SEI 7-05
 - ACI 318-08
 - ANSI/ AISC 360-10

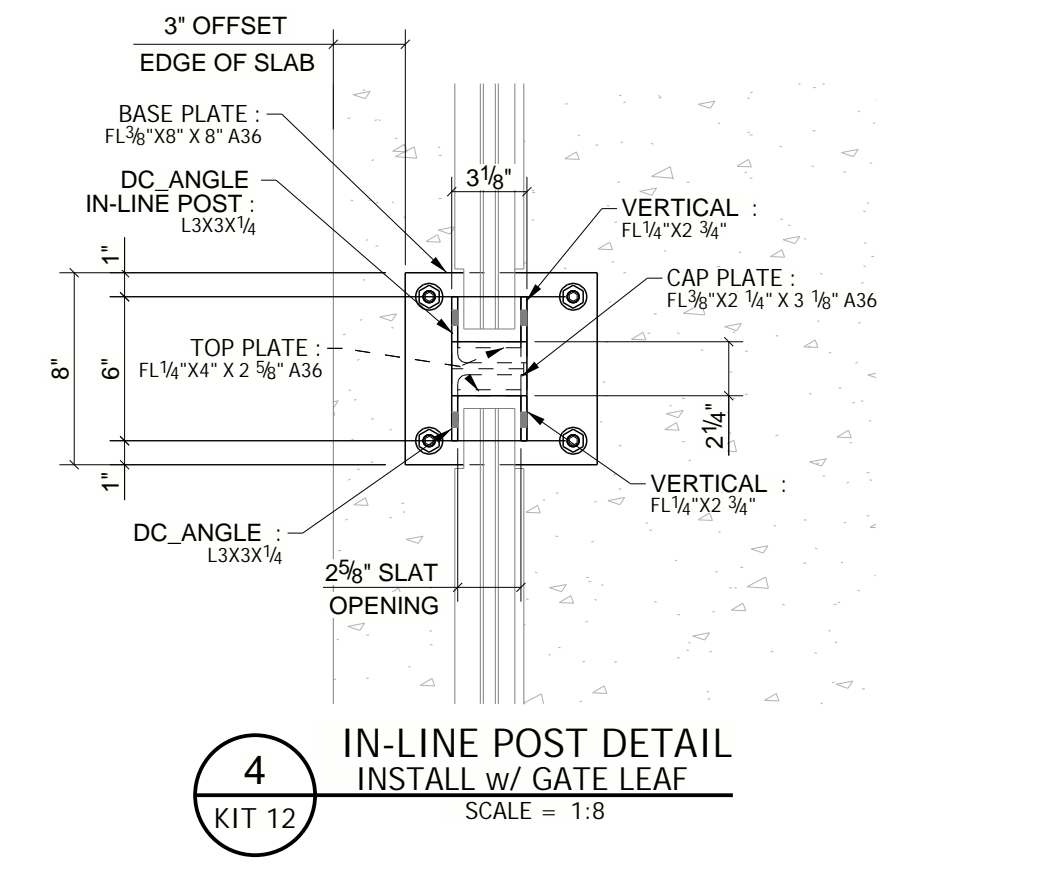

- KIT 12 CONTAINS:**
- BASE PLATE TEMPLATE (GA. MATERIAL/SIM)
 - CORNER WALL POSTS
 - IN-LINE WALL POSTS
 - RECT-TUBES
 - 68" LG OFFSET BLOCK SLATS
 - GATE PANELS FURNISHED w/ STEEL METAL FABRIC SHOWN
 - DROP ROD ATTACHED TO GATE LEAF
 - WEDGE ANCHORS (HDG) ARE PROVIDED
 - FASTENERS FOR GATE LEAF HINGES PROVIDED

S-SERIES OFFSET BLOCK WALL SPECIFICATIONS

CORNER POST - CP1 = 113lbs
 (4) CP1'S REQ'D = 453lbs
 IN-LINE POST - LP1 = 95lbs
 (3) LP1'S REQ'D = 286

68" DURA-CRETE SLAT WT# = 94lbs
 CITY OF DURA-CRETE SLATS REQ'D = 9 PER SLAT WALL 54 TOTAL
 WEIGHT = 5076 POUNDS TOTAL

CONCRETE PAD AND PAD REQUIREMENTS SHOWN ARE MADE AND VERIFIED BY OTHERS

ALL EXPOSED STEEL FRAMING IS GALVANIZED. ALL HARDWARE TO HAVE RESISTANCE TO OUTDOOR ELEMENTS

REV	DATE	DESCRIPTION	BY
		23450 REGENCY PARK DR. WARREN, MI 48089 P: 586.759.4286 www.duracretewalls.com	
PLEASE NOTE: THESE DRAWINGS REPRESENT DURA-CRETE WALLS INTERPRETATION OF THE INTENT OF THE CONTRACT DOCUMENTS. EVERY EFFORT HAS BEEN MADE TO ENSURE THAT THEY ARE ACCURATE AND COMPLETE. APPROVAL BY THE AUTHORIZED PARTIES SHALL CONSTITUTE ACCEPTANCE, AND ANY POST-APPROVAL CHANGES WILL BE CONSIDERED TO BE CHANGES TO DURA-CRETE WALLS CONTRACT.			
CLIENT: ORDER NUMBER: PROJECT NAME: PROJECT LOCATION: STREET: CITY: STATE: PROJECT DESCRIPTION: KIT-12 DUMPSTER GATE w 11'-2 3/4" WD GATE		SHEET NUMBER: KIT 12	
copyright Dura-Crete Products 2023. patent pending		DRAWN BY: C2M CHECKED BY: RW ORDER DONE BY: DATE OF ORDER:	

